



**VESTEL WHITE GOODS
CUSTOMER SUPPORT**

VESTEL REFRIGERATOR SERVICE MANUAL

VESTEL MODEL :	CUSTOMER MODEL :	CUSTOMER :	PRODUCT CODE:
RN 110K	RS 12	GREECE / CARAD	10021010

<i>CONTENTS</i>	<i>PAGE</i>
<i>1. SPECIFICATIONS</i>	1-2
<i>2. ASSEMBLE & DISASSEMBLE</i>	
❖ <i>Changing the doorway to right hand</i>	3-5
❖ <i>Changing the thermostat</i>	6
❖ <i>Thermostat knob</i>	6
<i>3. REFRIGERANT CYCLE DIAGRAM</i>	7
<i>4. COMPRESSOR AREA VIEW</i>	8
<i>5. CIRCUIT DIAGRAM</i>	8
<i>6. INTERIOR PARTS</i>	9
<i>7. INTERIOR PARTS LIST</i>	10
<i>8. DOOR PARTS</i>	11
<i>9. DOOR PARTS LIST</i>	12
<i>10. UNIT PARTS</i>	13
<i>11. UNIT PARTS LIST</i>	14

VESTEL WHITE GOODS	VESTEL REFRIGERATOR	JUNE 2003
	SPECIFICATIONS	

SPECIFICATIONS

	RS 12
CLIMATE TYPE	NORMAL
DOOR COLOR	WHITE
DOOR	2 SIDE AVAILABLE
DOOR INSULATION	CYCLOPENTANE
INSULATION	CYCLOPENTANE
LEVELLING FOOT	1
REFRIGERATOR GASKET	WHITE
FREEZER GASKET	WHITE

ELECTRICAL SPECIFICATIONS

	RS 12
ENERGY CLASS	B
COMPRESSOR	THA55YP (220-240V/50HZ)
POWER	72 W
LAMP TYPE	E14/220-240V/15W
CURRENT	0.5 A
REFRIGERANT	R 134a
REFRIGERANT CHARGE	60 gr.

RELAY

	RS 12
RELAY TYPE	MSDA3 & 8EA703
THERMIC TYPE	4TM104KFBYY

REFRIGERATING SYSTEM CONTROL

	RS 12
THERMOSTAT TYPE	DNFS077B6715
DRYER	7.5 gr.
DEFROST TYPE	Manuel
CAPILLARY TUBE	0.71x2500 mm

VESTEL WHITE GOODS	CUSTOMER SUPPORT
---------------------------	-----------------------------------

VESTEL WHITE GOODS	VESTEL REFRIGERATOR	JUNE 2003
	SPECIFICATIONS	

TEMPERATURE CONTROL(MAX.)

	RS 12
CUT IN	3.5 ± 1.5 °C
CUT OUT	-25.0 ± 1.5 °C

TEMPERATURE CONTROL (MIN.)

	RS 12
CUT IN	3.5 ± 1.5 °C
CUT OUT	-12.7 ± 2.0 °C

DIMENSIONS

	RS 12
REFRIGERATOR VOLUME GROSS (l)	79
FREEZER VOLUME GROSS (l)	12
WEIGHT (kg)	26.15
HEIGHT (mm)	838
DEPTH (mm)	579
WIDTH (mm)	480

PACKAGED DIMENSIONS

	RS 12
WEIGHT (kg)	28.7
HEIGHT (mm)	878
DEPTH (mm)	587
WIDTH (mm)	519

REFRIGERATOR ACCESSORY

	RS 12
ICE TRAY	1
CRISPER	1
CRISPER COVER	1
SHELF	1
TUNNEL DRAIN PLUG	1

VESTEL WHITE GOODS	CUSTOMER SUPPORT
---------------------------	-----------------------------------

VESTEL WHITE GOODS	VESTEL REFRIGERATOR	JUNE 2003
	ASSEMBLE & DISASSEMBLE	

A- Changing The Door Swing Direction to Right Hand

1- Lie down the appliance to the left side. (FIG-1)

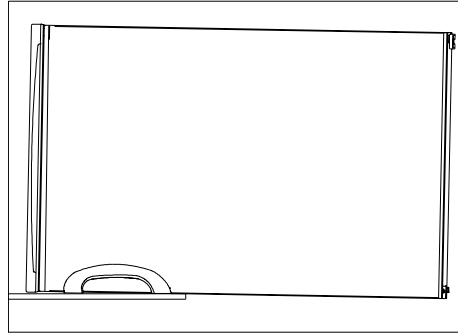

Figure - 1

2- Loosen two screws, which are fixing the bottom hinge. (FIG-2)

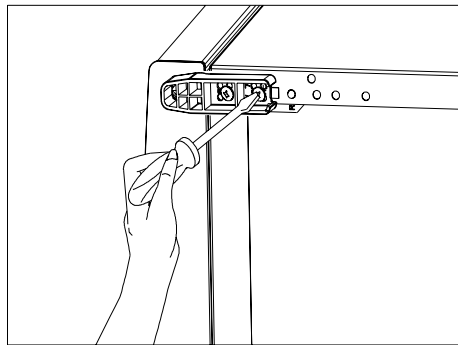

Figure - 2

3- Dismantle the bottom hinge. (FIG-3) and unscrew the leveling feet.

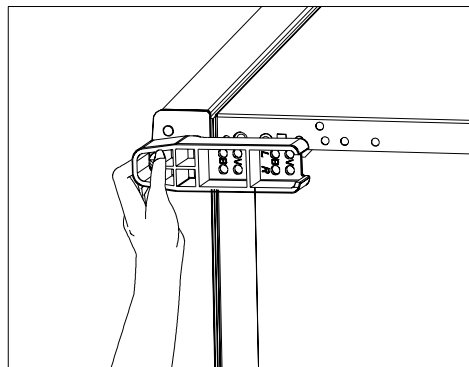

Figure - 3

VESTEL WHITE GOODS	CUSTOMER SUPPORT
---------------------------	-----------------------------

VESTEL WHITE GOODS	VESTEL REFRIGERATOR	JUNE 2003
	ASSEMBLE & DISASSAMBLE	

4- Remove out the door. (FIG-4)

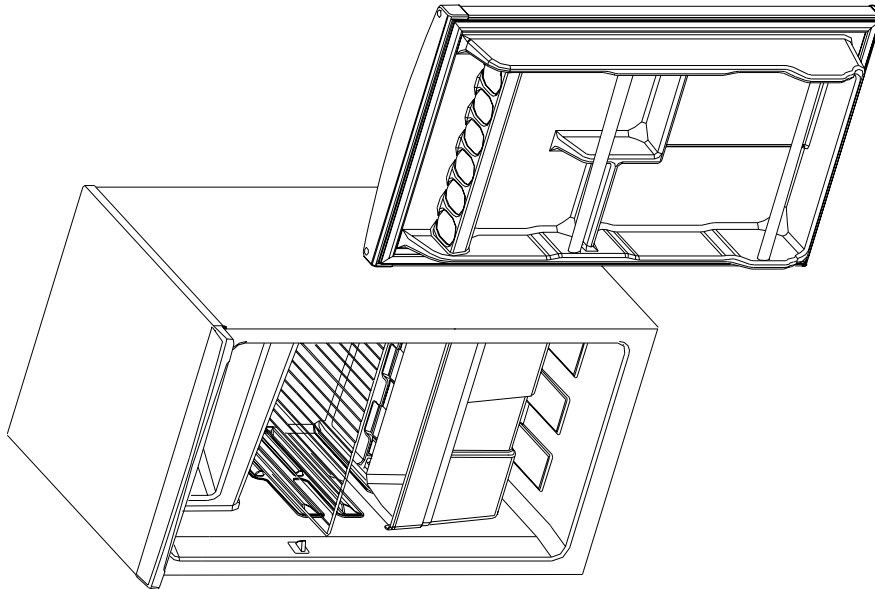

Figure - 4

5- Remove the door handle caps. Unscrew the screws that are fixing the door handle. Assemble door handles to the right side by doing the reverse operation.

6- Replace the bushing with the bushing cap on top of door. Change the placement of bushing on the bottom of the door. (FIG-5)

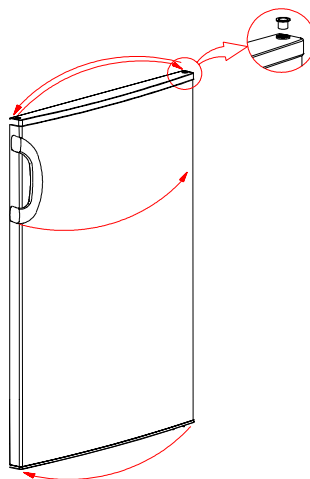

Figure - 5

VESTEL WHITE GOODS	CUSTOMER SUPPORT
---------------------------	-----------------------------

VESTEL WHITE GOODS	VESTEL REFRIGERATOR	JUNE 2003
	ASSEMBLE & DISASSAMBLE	

7- Screw the bottom hinge to the right side. Use holes signed by V for Vestel, Softline and Classic designed doors, holes signed by B for Bonfanti designed doors. For door reversing operation, use holes signed by R for right hand side and holes signed by L for left hand side opening. (FIG-6) Finally, screw the leveling foot to left hand side.

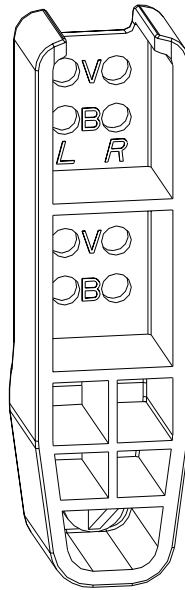

Figure - 6

VESTEL WHITE GOODS	CUSTOMER SUPPORT
---------------------------	-----------------------------

VESTEL WHITE GOODS	VESTEL REFRIGERATOR	JUNE 2003
	ASSEMBLE & DISASSAMBLE	

B - Changing The Thermostat :

- 1) Remove the lamp cover and unscrew the fixing screw.
- 2) Remove the screw cap and unscrew the fixing screw.
- 3) Remove the thermostat by pulling and disconnecting the wire connector.
- 4) Pull out the thermostat bulb from the housing.
- 5) Remove the thermostat knob by pulling forward. Loosen the nut fixing the thermostat.
- 6) Replace the thermostat and assemble the thermostat cover following the steps backwards.

C - Thermostat Knob

- ❖ This knob is used to control the temperature of the freezer and refrigerator automatically. It can be set to any value between the "0" and "5" positions.
- ❖ "0" position indicates that the thermostat is "off". The refrigerator is "off" in this setting.
- ❖ By turning the knob from "1" to "5" you can increase the cooling degree.
- ❖ The refrigerator is designed to get optimum performance when the thermostat knob is set in the middle position (position "3")

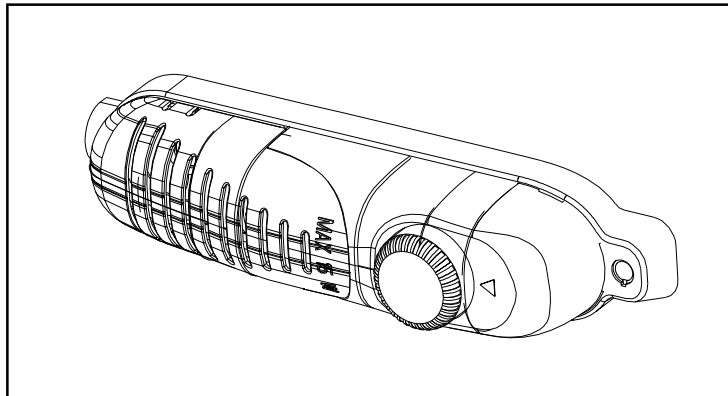

VESTEL WHITE GOODS	CUSTOMER SUPPORT
---------------------------	-----------------------------

VESTEL
WHITE GOODS

VESTEL REFRIGERATOR
REFRIGERANT CYCLE DIAGRAM

JUNE
2003

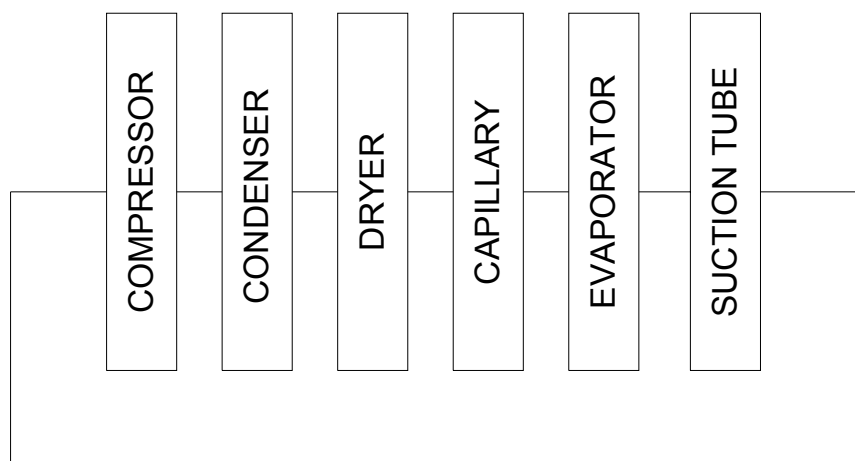
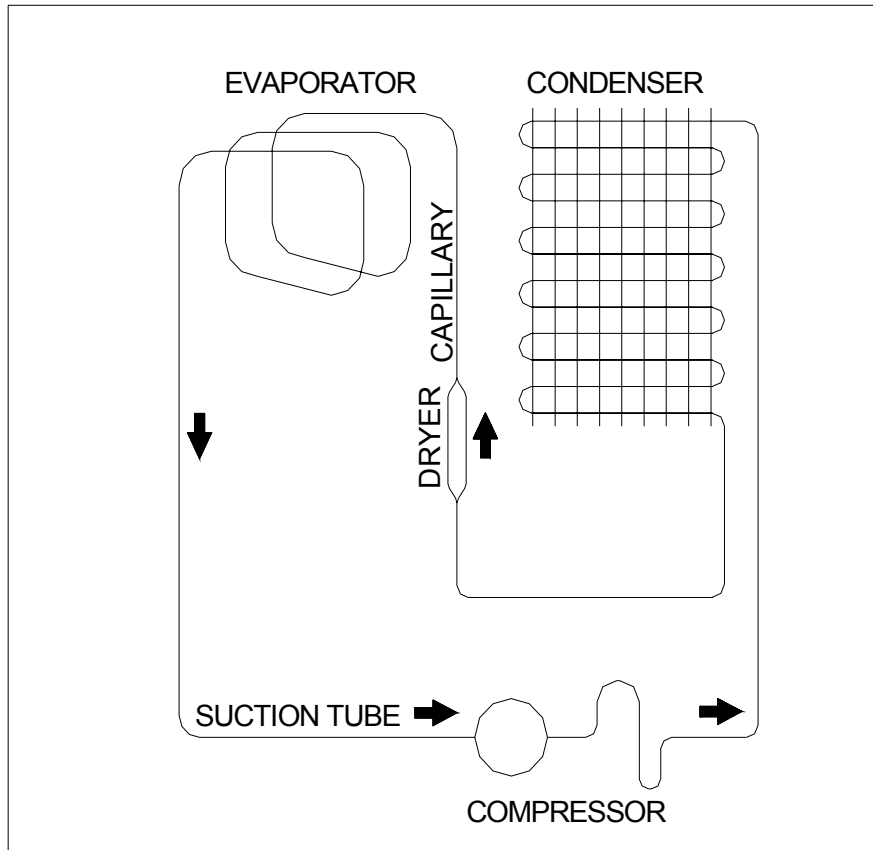

VESTEL WHITE GOODS

CUSTOMER
SUPPORT

**VESTEL
WHITE GOODS**

VESTEL REFRIGERATOR
COMPRESSOR AREA VIEW & CIRCUIT DIAGRAM

**JUNE
2003**

COMPRESSOR AREA VIEW

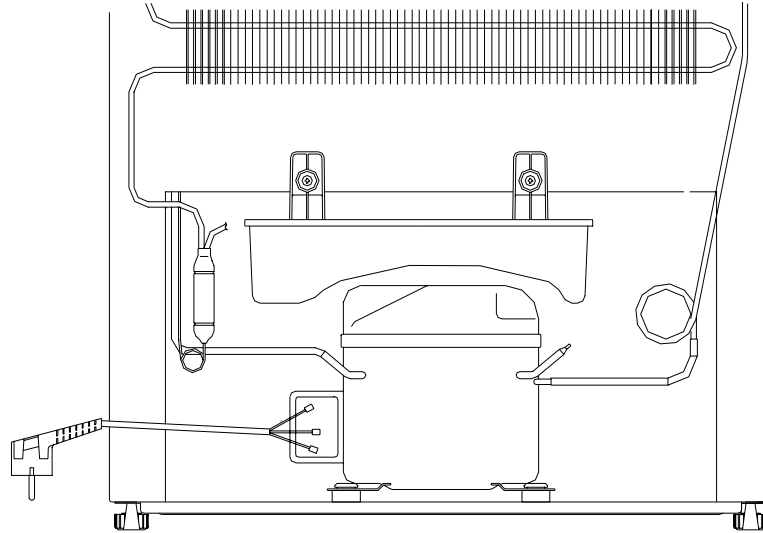

CIRCUIT DIAGRAM

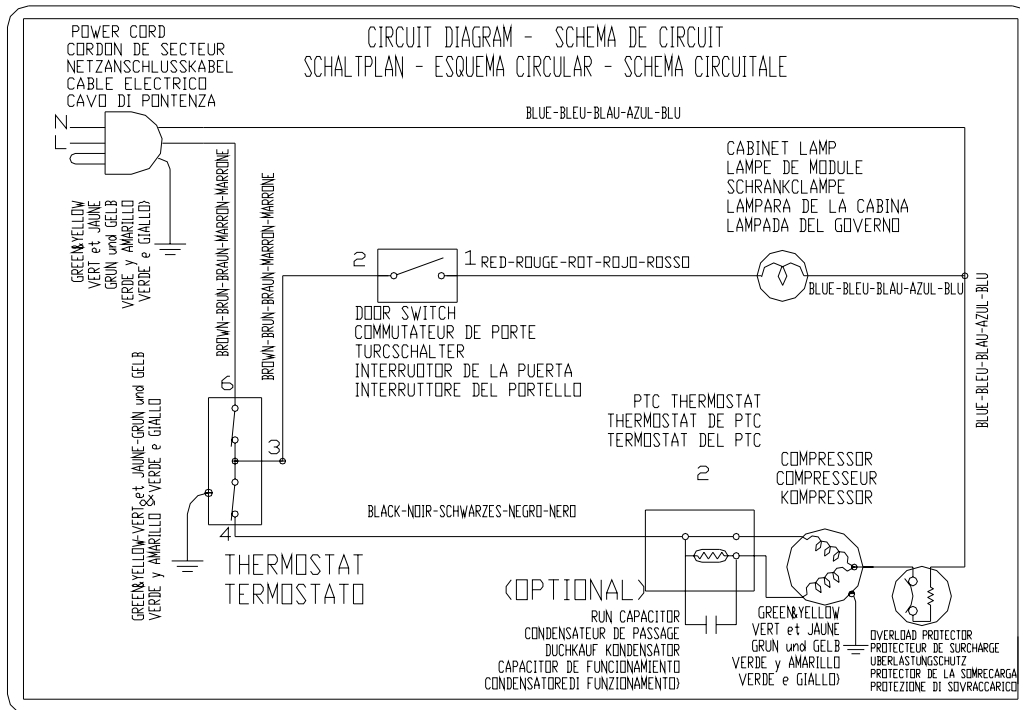

VESTEL WHITE GOODS

**CUSTOMER
SUPPORT**

VESTEL
WHITE GOODS

VESTEL REFRIGERATOR
INTERIOR PARTS

JUNE
2003

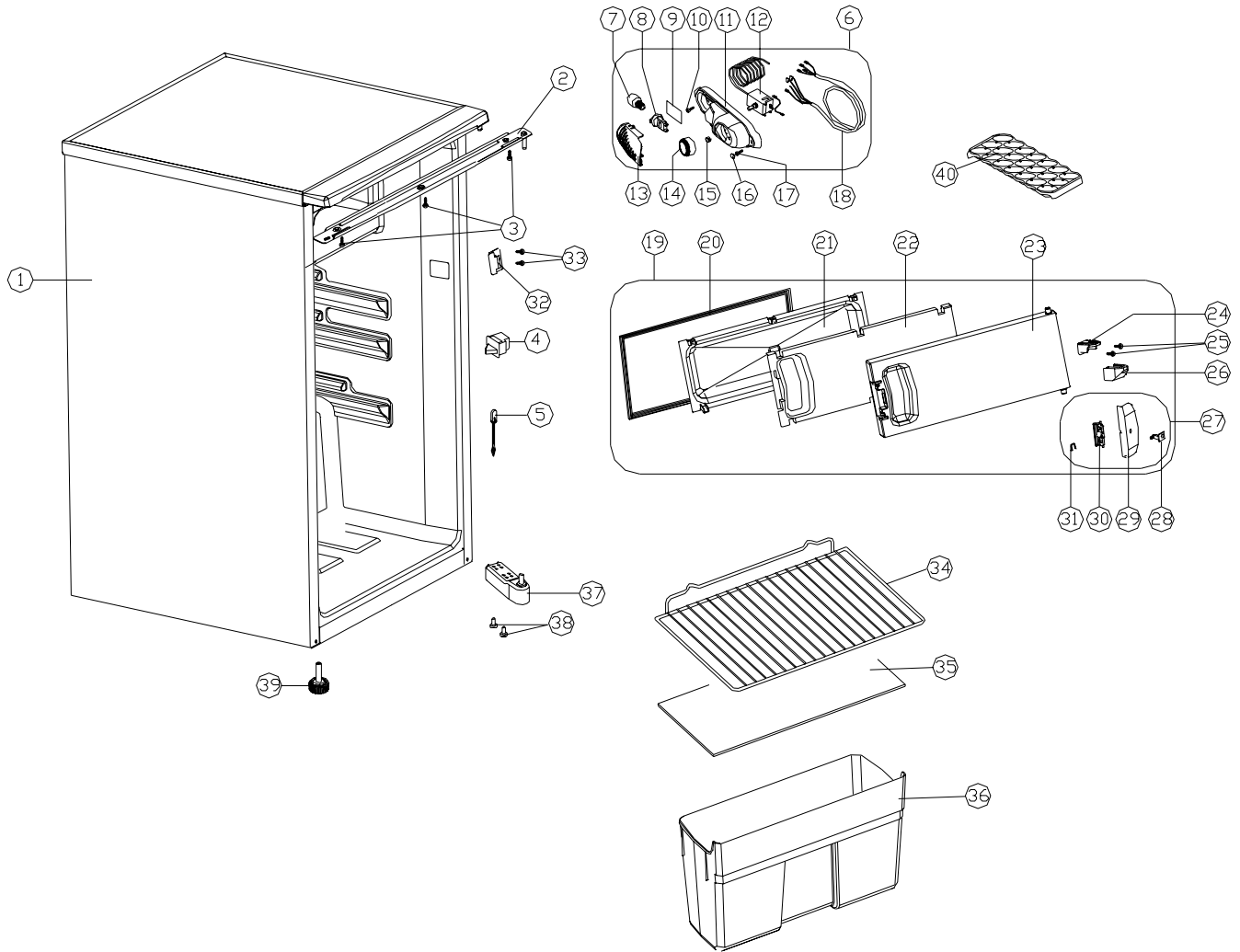

VESTEL WHITE GOODS

CUSTOMER
SUPPORT

VESTEL WHITE GOODS	VESTEL REFRIGERATOR	JUNE 2003
	INTERIOR PARTS LIST	

NO	CODE	PART NAME	RS 12
1	20105396	ASSY URT CAB/110N	1
2	35005584	TOP HINGE COVER/110	1
3	35000717	SCREW KA 40*8 WN 1412 EJOT	3
4	30007915	DOOR SWITCH	1
5	40002216	TUNNEL DRAIN PLUG	1
6	30019150	THERMOSTAT BOX ASSY/110	1
7	30007906	LAMP (E14/220-240V/15W)	1
8	30007907	LAMP HOLDER	1
9	45000976	HEAT REFLECTOR FOIL/140	1
10	35003482	SCREW PLS KA 40*13(INOX-S.UÇ)SUS 430	1
11	40011081	THERMOSTAT BOX/110	1
12	30017122	THERMOSTAT(DNFS077B6715)265	1
13	40013235	LAMP COVER/110	1
14	40008121	THERMOSTAT KNOB SRGF/260	1
15	35000730	SPRING	1
16	40003904	PLUG,THERM. BOX SCREW/140	1
17	35000744	SCREW KA 40*18 WN 1411(INOX-SİV.UÇ)EJOT	1
18	30020451	WIRING HARNESS/THERMOSTAT/150 (WITH SWITCH)	1
19	40011088	F DOOR ASSY/110 SRGF	1
20	40011101	F DOOR GASKET/110	1
21	40011091	F BACK DOOR/110	1
22	50029691	F DOOR PAD/110	1
23	40011090	F FRONT DOOR SRGF/110	1
24	40002226	F DOOR HINGE	1
25	35000744	SCREW KA 40*18 WN 1411(INOX-SİV.UÇ)EJOT	2
26	40002229	F DOOR HINGE COVER	1
27	40003862	F DOOR HANDLE ASSY/340	1
28	40002238	F DOOR LOCK INDICATOR COVER/340	1
29	40002231	F DOOR HANDLE	1
30	40002233	F DOOR LOCK	1
31	35005861	F DOOR SPRING	1
32	40002230	F DOOR HOLDER	1
33	35003482	SCREW PLS KA 40*13(INOX-S.UÇ)SUS 430	2
34	45003227	R COMPARTMENT SHELF/110	1
35	45002759	CRISPER COVER/110	1
36	40013780	CRISPER SRGF/110	1
37	40011092	BOTTOM HINGE/110	1
38	35000714	SCREW M5*14 WN 1342-H EJOT	2
39	45000563	LEVELLING FOOT	1
40	40010584	ICE TRAY/160	1

VESTEL WHITE GOODS	CUSTOMER SUPPORT
---------------------------	-----------------------------

VESTEL WHITE GOODS	VESTEL REFRIGERATOR	JUNE 2003
	DOOR ASSY. PARTS	

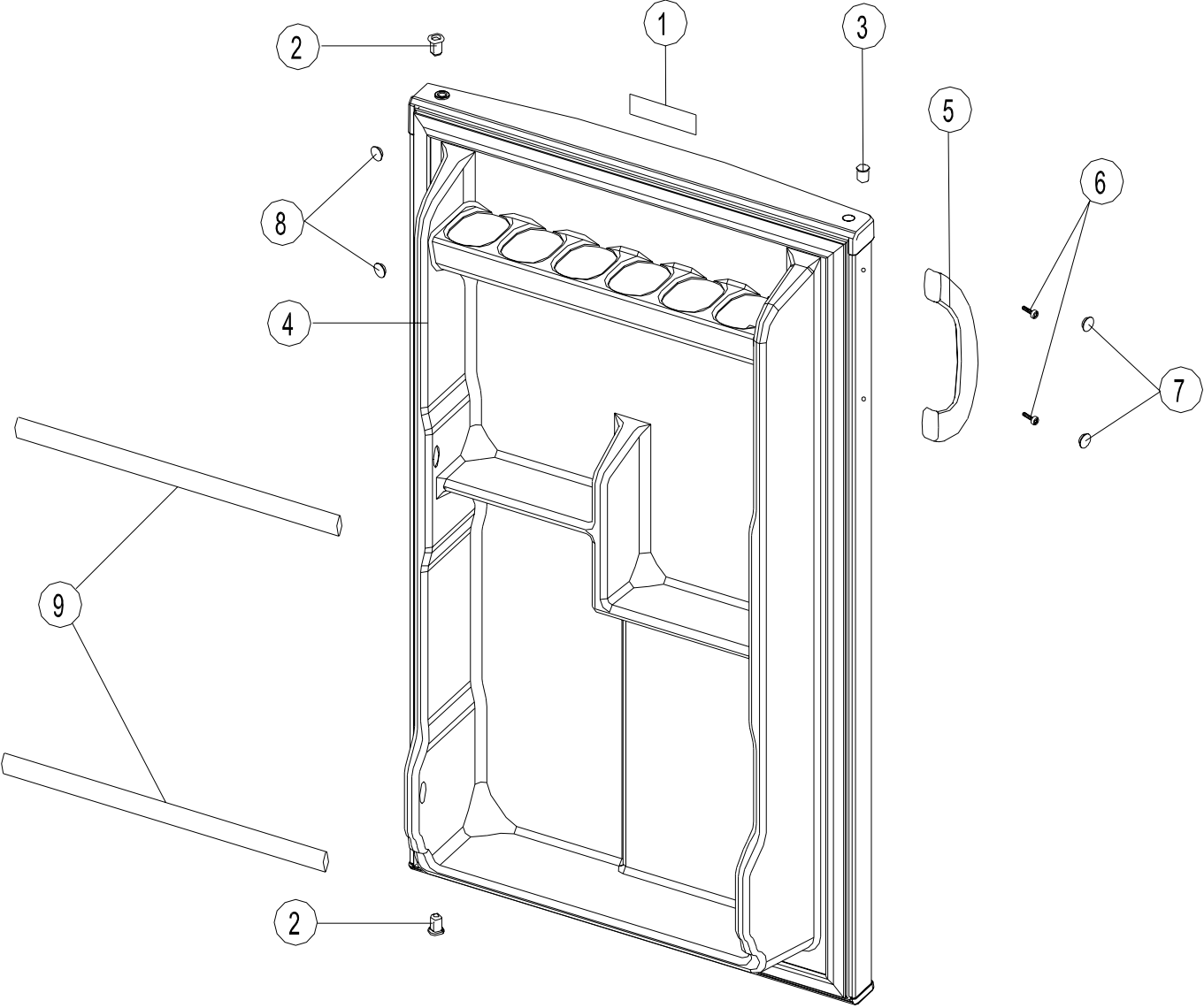

VESTEL WHITE GOODS	CUSTOMER SUPPORT
---------------------------	-----------------------------------

VESTEL WHITE GOODS	VESTEL REFRIGERATOR	JUNE 2003
	DOOR ASSY PARTS LIST	

NO	CODE	PART NAME	RS 12
1	45002336	LOGO CARAD	1
2	40006640	BUSHING/345S	2
3	40002243	BUSHING CAP	1
4	20116190	ASSY.DOOR/110K	1
5	20098511	HANDLE CLASSIC	1
6	35005747	SCREW M4*13 BN30-12-110 YSB PFL-BETZER	2
7	40009409	PLUG D10	2
8	40012428	CAP SMALL	2
9	40011086	DOOR SHELF TRIM/110	2

VESTEL WHITE GOODS	CUSTOMER SUPPORT
---------------------------	-----------------------------

VESTEL
WHITE GOODS

VESTEL REFRIGERATOR

JUNE
2003

UNIT PARTS

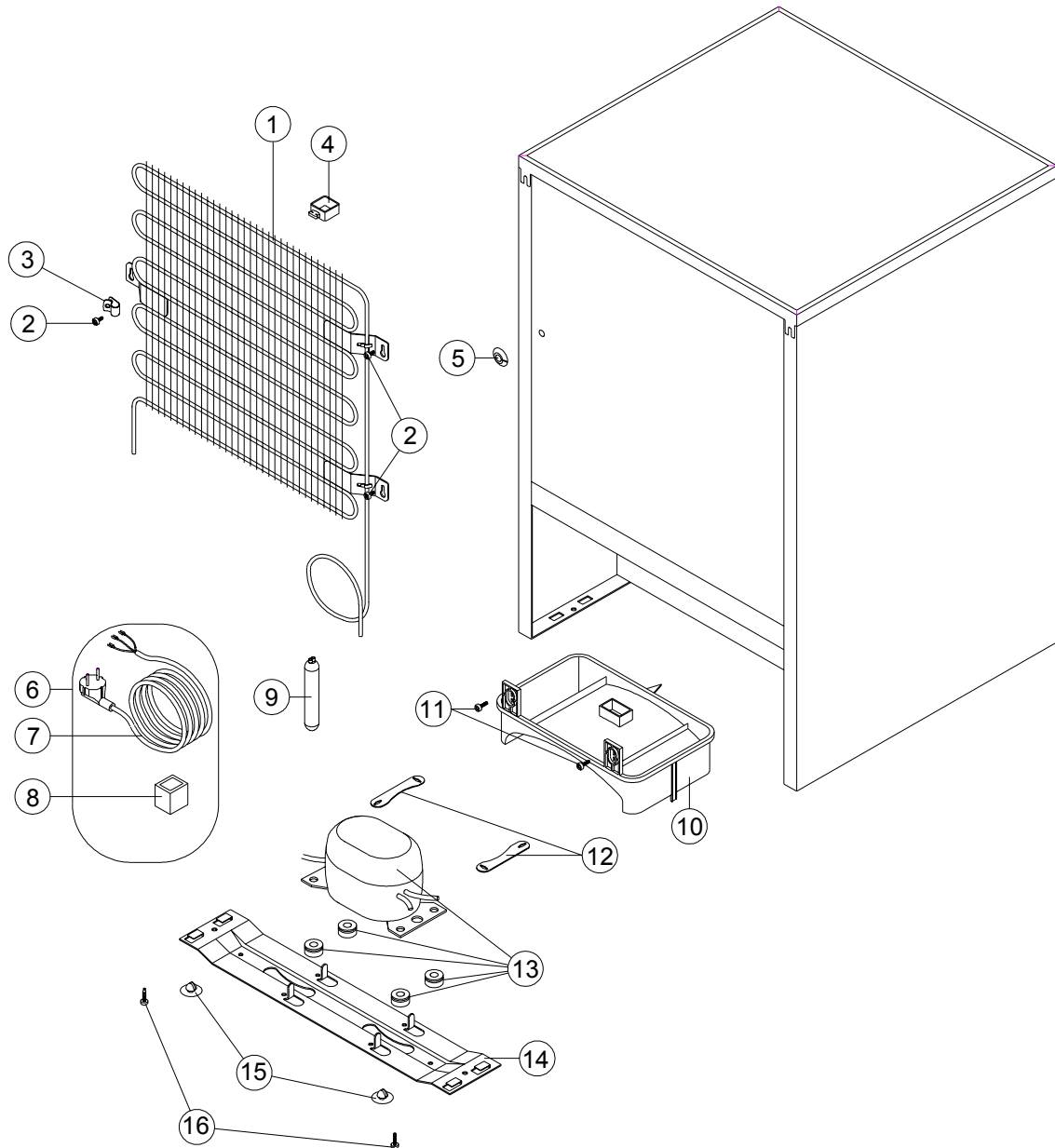

VESTEL WHITE GOODS

CUSTOMER
SUPPORT

VESTEL WHITE GOODS	VESTEL REFRIGERATOR	JUNE 2003
	UNIT PARTS LIST	

NO	CODE	PART NAME	RS 12
1	35005583	MAIN CONDENSER/110	1
2	35001817	SCREW 4.2*9.5 WITH WASHER	3
3	40006235	CABLE HOLDER / 140	1
4	40002180	SPACER	1
5	40003898	PLUG,CABLE HARNESS	1
6	30018604	POWER CORD GR.THA55YP/140	1
7	30010202	POWER CORD (1.5m)	1
8	30018603	OVER LOAD RELAY.THA55YP 220-240V/50HZ	1
9	35002601	DRYER (XH9,7.5GR)	1
10	40009953	EVAPORATING TRAY/260	1
11	35000743	SCREW 4.2*9.5 DIN 7981 YSB	2
12	20020023	COMPRESSOR FIXING BRACKET	2
13	30018602	COMPRESSOR (THA55YP 220-240V/50HZ)	1
14	20105415	COMP BASEMENT/110	1
15	40006283	FOOT	2
16	35000714	SCREW M5*14 WN 1342-H EJOT	2
	50037687	USER'S MANUAL/TT-DB.ENG	1
	50029433	CIRCUIT DIAGRAM/150-260	1
	50039496	ENERGY LABEL/110K(N) CARAD(RS12)	1
	20129055	NAME PLATE/110N CARAD-ENG(RS12)	1
	50020664	WARRANTY LABEL/CARAD	1
	20105414	PACKAGE GROUP/110 (CARTOON)	1
	50029695	PACKAGE CARTOON/110 STANDARD	1
	50029694	PACKAGE BAG (1125*1120*0.03) 110	0.12 kg. (1)
	50039497	PACKAGE LABEL/110K(N) CARAD-ENG(RS12)	2
	50029692	STYROFOAM UPPER/110	1
	50029693	STYROFOAM BOTTOM/110	1
	50008956	CUT PAD (742*152*12)	5

VESTEL WHITE GOODS	CUSTOMER SUPPORT
---------------------------	-----------------------------

REVISION SHORT HISTORY:

NO:	REV. NO:	REV. DATE:	PAGE NO:	REV. REASON
01	00	11.06.2003	All	First publication

DISTRIBUTION :

<i>Greece – Carad</i>	<i>Date: 11.06.2003</i>
-----------------------	-------------------------

PREPARED BY : Poyraz DOGACI
APPROVED BY : Deniz SPORER

PRINTED DATE : 11 JUNE 2003
DOCUMENT NO : 50041507